

## MOTORIDUTTORE AGTR-AR Gearmotor

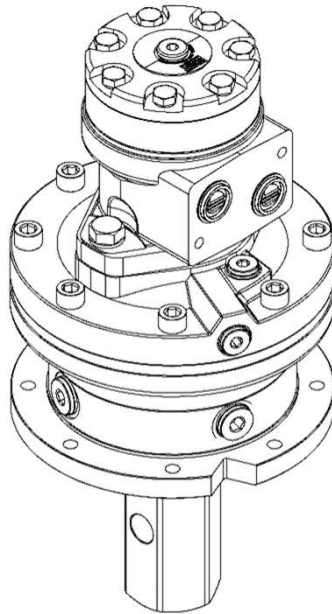

Peso tipico: 22 kg  
 Typical weight: 22 kg

### CODICE D'ORDINAZIONE – Order Code

<b>AGTR - A</b>	<b>R</b>	<b>####</b>	<b>N</b>	<b>50</b>	<b>/</b>	<b>...</b>
motori disponibili <i>available motors</i>  R: MMGLR (orbitale) R: MMGLR (orbital) (vedi tabella / see the table) <b>0834, 1034, 0842, 1234, 1042, 0857, 1242, 1634</b>		taglia <i>size</i>  <b>1242, 1634</b>	flangiatura <i>flange</i>  N: standard N: <i>standard</i>			altre opzioni <i>further options</i>
				albero d'uscita <i>output shaft</i>  <b>50: Esagonale Ch.50</b> 50: <i>Exagonal Ch.50</i>		

### DIMENSIONI ESTERNE e CARICHI – External Dimensions & Loads

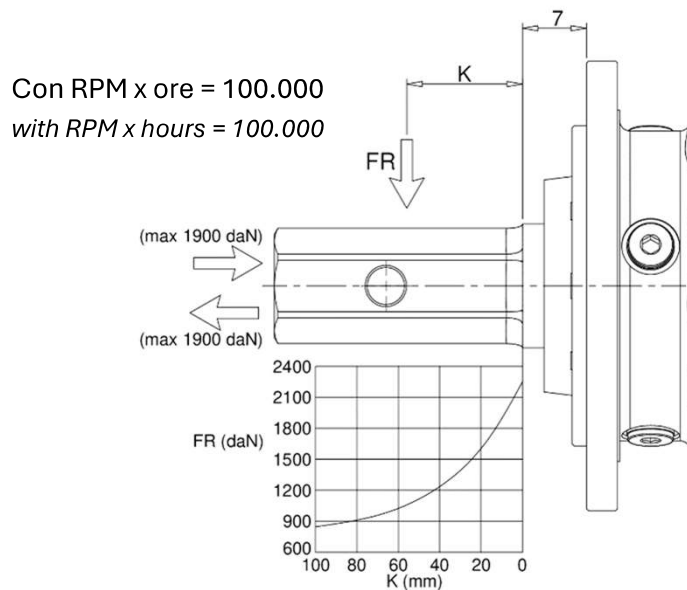

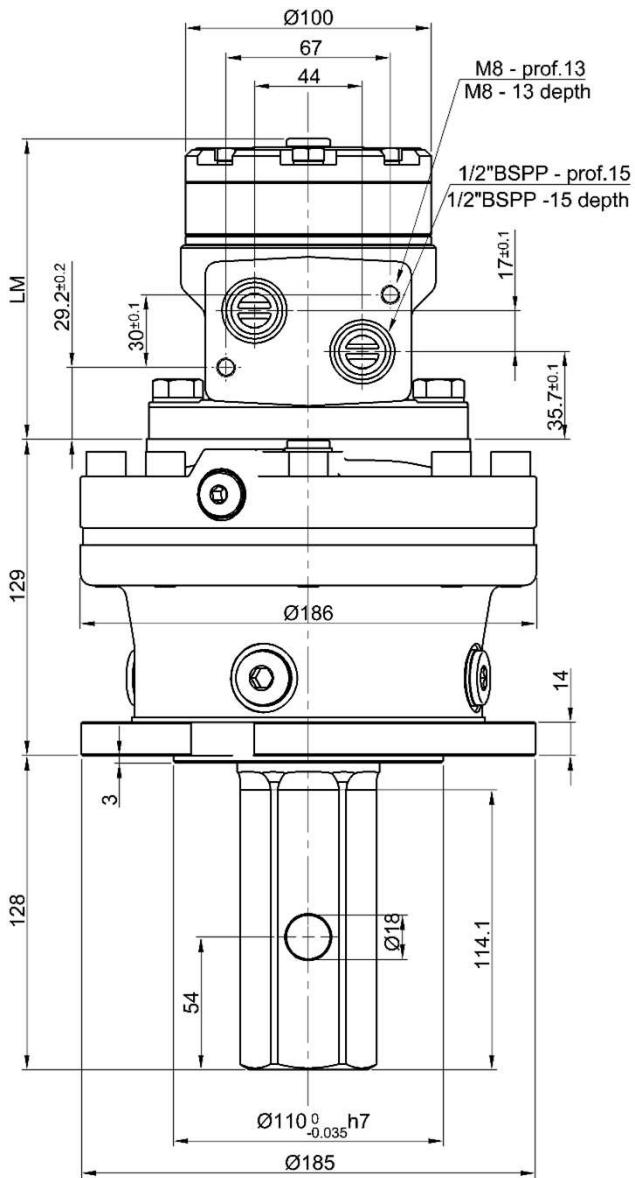

Taglia Size	LM LM
0834	115
1034	118
0842	115
1234	123
1042	118
0857	115
1242	123
1634	129

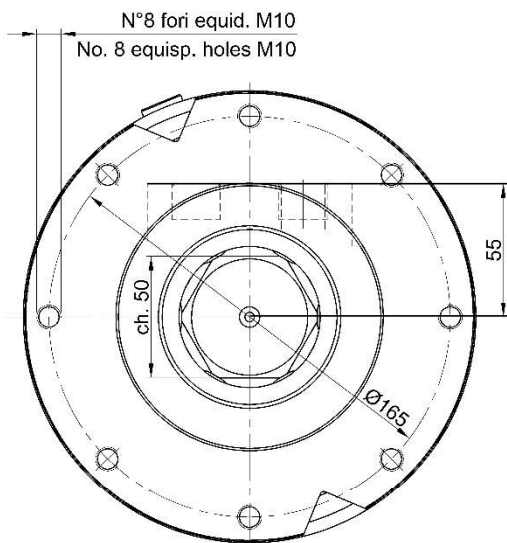

Flangiatura N  
N flange